

Emulsification
and High Shear
Applications



High Shear

Magnetic Mixer

The Metenova HS High Shear mixer offer a rotor/stator aseptic magnetic mixer for your critical fine emulsions and dispersions. Metenovas High Shear mixers disperse droplets and creates an even particle size distribution, enabling down-stream high pressure emulsification processing. It also improves the suspension characteristics of the product. The Metenova HS is ideal for emulsification applications, difficult to dissolve solids and particle downsizing.

Basic Selection

	HS2	HS5	HS8
Max Volume at 1 cP [ltr]	120	800	1500
Max Speed [rpm]	3900	3900	3500
Shear Rate	27000	36000	32000



The information in this publication is subject to change without prior notice. The information in this document is believed to be complete and accurate at the time of publication. Metenova assumes no responsibility for any errors that may appear in this document. Customer is responsible for determining Metenova's product will perform suitable in the intended application.

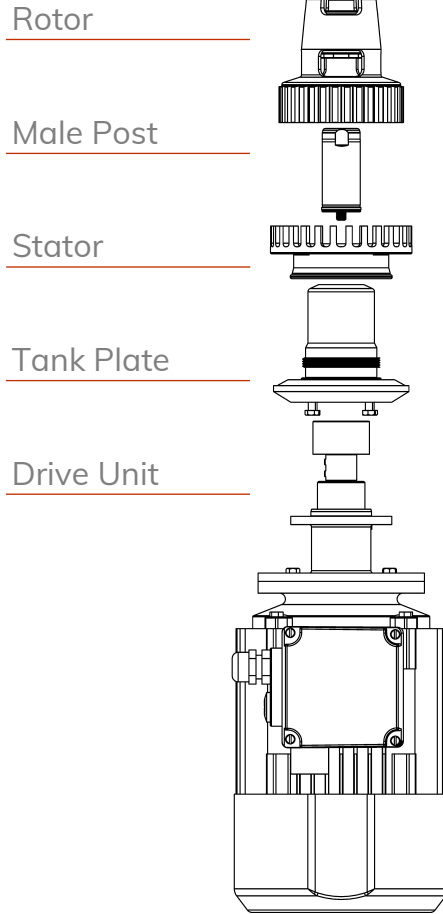

**General guide for components detail specification data sheet
(More variation options available for each subcomponent)**

Rotor	Male Post	Stator	Tank Plate	Drive Unit
DS-034 HS Rotor	DS-045 ZG Male Post	DS-035 HS Stator	DS-036 HS Tank Plate Welded	DS-033 HS Drive Unit E0

Net Weight (approximate)

Mixer Model	HS2	HS5	HS8
Weight kg (lb)	9 (20)	29 (64)	84 (185)

Additional information

Operating Temp	5°C - 150°C (41°F - 302°F) Environment Temp 0°C - 40°C (32°F - 104°F)
Operating Pressure	-1 – 7 barg (-14.5 – 101.5 psig)
Surface Roughness	Ra ≤ 0.38 µm (15 µin)
Surface Treatment	Electro polished. Non animal origin polishing compounds are used.
Product contact material	Standard SS material 316L, bearing material SIC and elastomers EPDM (USP VI, FDA compliant). Other material options available upon request.